



# CITY PRIDE

elevate your lifestyle in the heart of city

◆ HAJIGANJ, PATNA CITY ◆

YOUR  
PERFECT  
HOME  
IN THE  
CITY!



**MODERN ELEGANCE, TIMELESS COMFORT,  
YOUR PERFECT HOME!**

Welcome to your dream home, where modern design meets timeless elegance. This stunning residence boasts a captivating front view, showcasing architectural brilliance and meticulous landscaping. Every detail, from the grand entrance to the lush greenery, invites you to experience luxury and comfort in a truly serene setting.

WHERE LIFE IS A RETREAT.

## SOPHISTICATION BEGINS AT YOUR ENTRANCE.

Experience exceptional security and sophistication at our residential project. Our striking gate view offers a welcoming, elegant and secure entrance to your dream living space.



Experience the best of both worlds with our residential and commercial project amenities. Enjoy modern living spaces, state-of-the-art fitness centers, serene green areas, and convenient retail options—all within a vibrant, well-connected community designed for your comfort and convenience.



50% Open Area



Children's Play Area  
With Swing & Slides



30% Green Area



## SPECIAL FEATURES

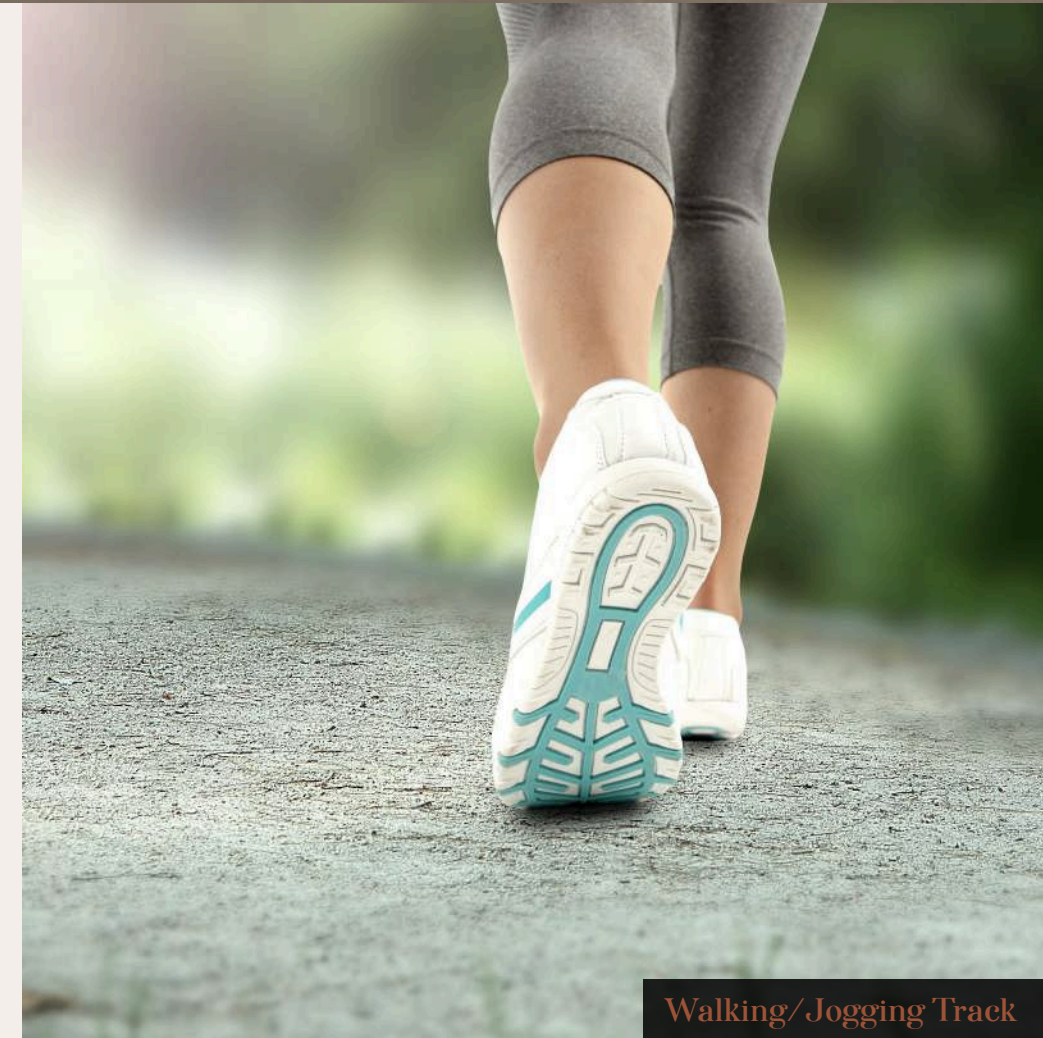

Walking/Jogging Track

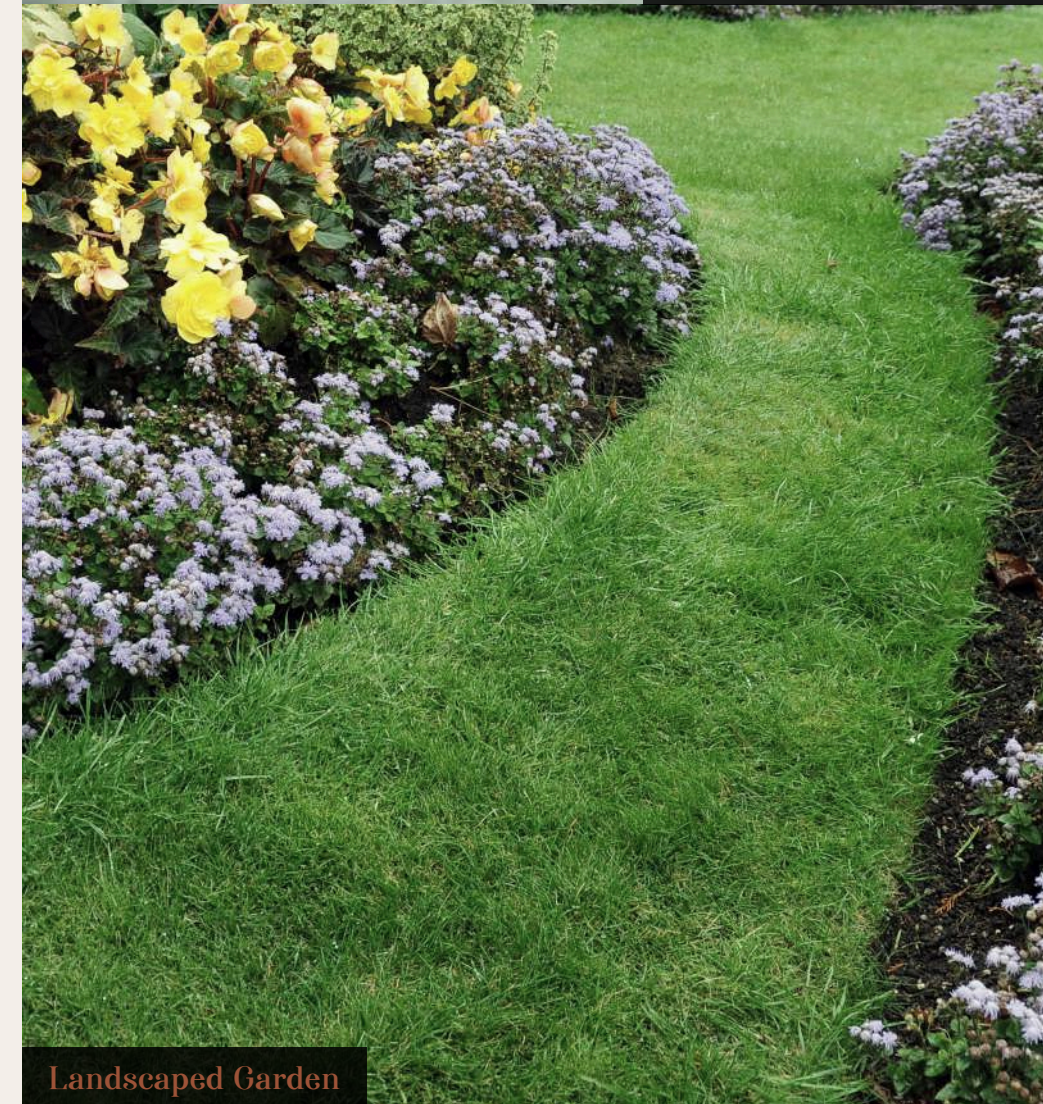

Landscaped Garden

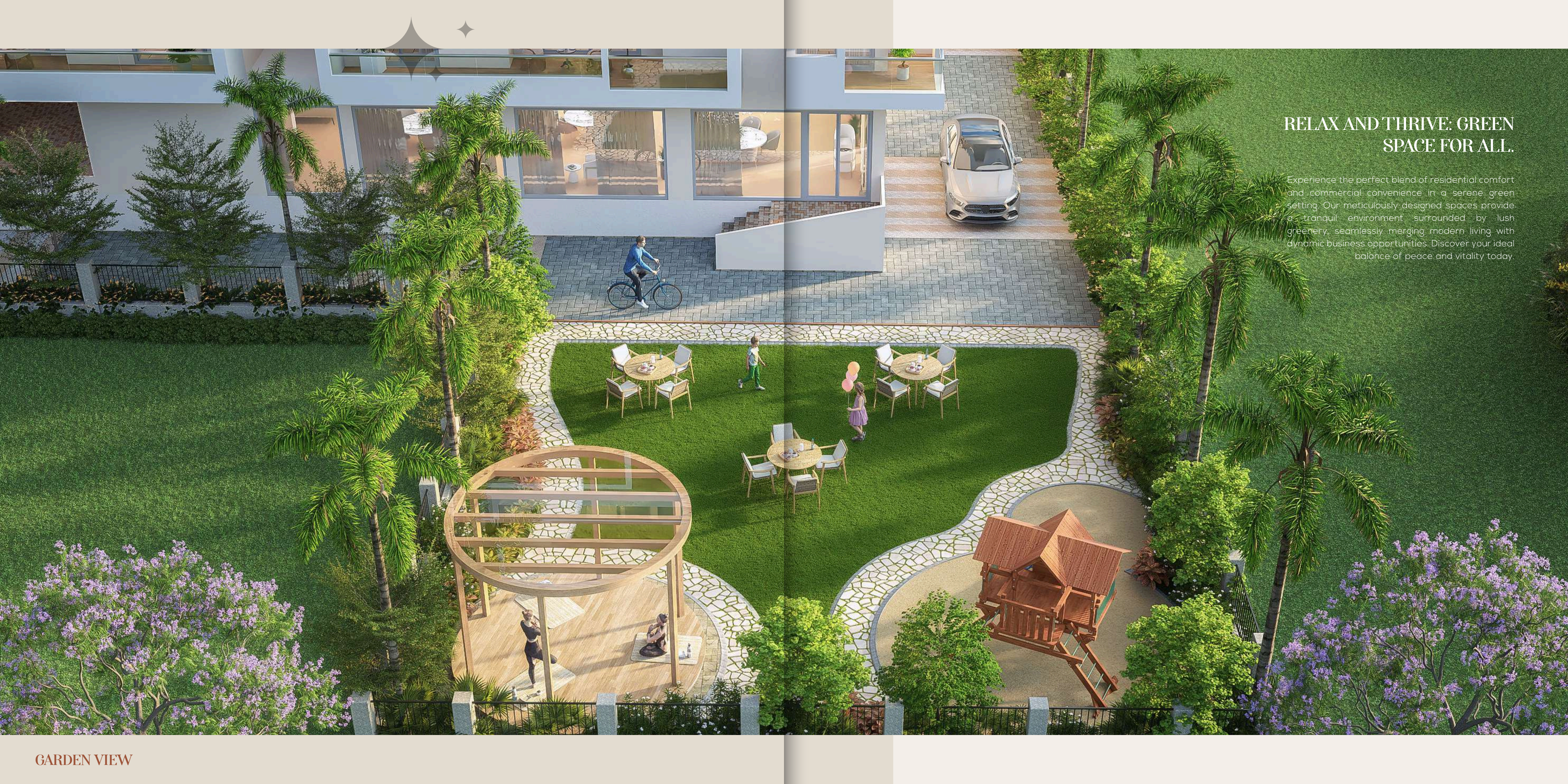

## RELAX AND THRIVE: GREEN SPACE FOR ALL.

Experience the perfect blend of residential comfort and commercial convenience in a serene green setting. Our meticulously designed spaces provide a tranquil environment surrounded by lush greenery, seamlessly merging modern living with dynamic business opportunities. Discover your ideal balance of peace and vitality today.



URBAN LIVING  
MEETS COMMERCIAL CONVENIENCE.

Confront a harmonious blend of luxury living and vibrant commerce from our top view perspective. This residential and commercial project offers a panoramic vista of modern elegance and bustling energy, seamlessly integrating comfort with dynamic business opportunities. Discover your perfect space today.

## WHERE RESIDENTIAL COMFORT MEETS COMMERCIAL ELEGANCE.

Welcome to a dynamic blend of modern living and business innovation. Our residential and commercial project features a striking facade, seamlessly integrating style and functionality. Experience a vibrant community where your home and business thrive in perfect harmony.



FRONT VIEW

Experience modern living at its finest with our residential-cum-commercial project. Enjoy luxurious amenities including a swimming pool, fitness center, landscaped gardens, and retail shops, all designed to provide convenience and comfort in a vibrant community. Discover your ideal lifestyle today.

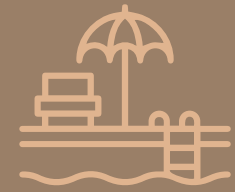

Infinity Pool

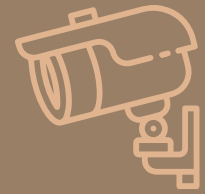

CCTV Camera  
For Common Area



Visitors Car  
Parking Space



## SPECIAL FEATURES



Gymnasium



Community



24 X 7 Security





## LUXURY LIVING WITH STUNNING POOL VIEWS.

Experience the ultimate blend of luxury and convenience with our residential-cum-commercial project. Enjoy breathtaking aerial views of the stunning swimming pool, perfect for relaxation and recreation, all within a vibrant community designed to enhance your lifestyle.





## WHERE WORK SEAMLESSLY, INTEGRATES WITH HOME LIFE.

Experience the ideal fusion of residential comfort and commercial convenience with the distinctive road view of our project. This forward-thinking development integrates contemporary living spaces with dynamic commercial prospects, creating a vibrant community where luxury and convenience converge. Benefit from immediate access to essential amenities and a flourishing environment just steps from your doorstep.



KEY DISTANCE

 Patna Saheb Railway Station 1.5 KM	 Jayprakash Narayan International Airport 19 KM	 ISBT Patna Bus Stop 8 KM
<p><b>BANK</b></p> <hr/>		
<p><b>COLLEGE</b></p> <hr/>		
<p><b>HOTELS</b></p> <hr/>		
<p><b>FAMOUS PLACES</b></p> <hr/>		
<p><b>HOSPITALS</b></p> <hr/>		
<p><b>MANDIR</b></p> <hr/>		
<p><b>PETROL PUMPS</b></p> <hr/>		

## SPECIFICATIONS

### FRAME STRUCTURE

Earthquake resistant rcc frame structure

### FINISHING OF INTERNAL WALLS

P.O.P./PUTTY over cement plaster.

### COMMON AREA WALL

Plastic paint over putty

### FINISHING OF EXTERNAL WALL

External acrylic water proof paint over texture

### WINDOWS & SLIDING DOORS

Glazed upvc/anodised aluminium of reputed make

### DOOR

Flush door of ISI mark

### DOOR FRAME

Sal Wood Frame

### FLOORING INSIDE FLAT

DRAWING, DINNING, KITCHEN

Vitrified 4'x2'/5'x2'6" or imported marble flooring

BED ROOM

Vitrified 4'x2' or 5'x2'6"

TOILET FLOOR

Anti-skid floor tiles

TOILET WALL

Ceramic tiles till 8' height

### LOBBY/PASSAGE

Granite flooring

### STAIR

Granite Floor

### KITCHEN

Granite Cooking platform with stainless steel sink

2' height ceramic tiles dado over cooking platform

### WINDOW SEAL

Granite



### TOILET

Cp & sanitary fittings of jaquar/grohe/kohler or equivalent.

### ELECTRIFICATION

Concealed electrical wiring with modular switches of havells/norisys/legrand make or equivalent. Internal conduit wiring for A.C.'s.

## COMMON SERVICES

### WATER SUPPLY

Through overhead tank from Two Nos. deep tube well boring

### GENERATOR FACILITY

Sound Proof Generator for Common Area, Lift, & 1000 Watts Each Flat

### LIFTS

2 nos of lift of kone/otis/schindler make or equivalent.

### FIRE FIGHTING SYSTEM

As per norms

### INTERCOM

Intercom Facility with One Nos. Handset to each flat.

### CCTV

The whole campus is cctv secured

### Note

All floor plans, layouts & specifications are indicative and are subject to change. Soft finishing and furnishing are not part of the offering. Photographs used in this brochure are artist impression for illustration purpose only.



## WHERE WORK MEETS HOME, SEAMLESSLY INTEGRATED.

Discover the perfect harmony of residential comfort and commercial convenience with our project's striking road view. This innovative development seamlessly blends modern living spaces with dynamic commercial opportunities, offering a vibrant community where convenience meets luxury. Enjoy easy access to essential amenities and a thriving environment right outside your door.



SIDE VIEW

# GROUND FLOOR WITH SITE PLAN



## LEGENDS

1. Entry
2. Exit
3. Driveway
4. Commercial Block
5. Car Parking
6. Car Wash Area
7. Society Office
8. Gymnasium
9. Community Hall
10. Kid's Play & Yoga Area
11. Temple
12. Commercial Lobby Area
13. Residential Lobby Area
14. Society Guest Room
15. Arrival Plaza



# UNIT PLANS

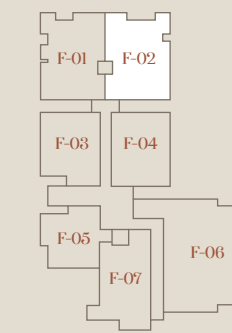

TYPICAL 1ST TO 6TH FLOOR  
UNIT F-02  
BHK - 3  
CARPET AREA - 1223 SQFT  
BALCONY AREA - 264 SQFT  
BUA - 1547 SQFT  
SBUA - 2089 SQFT

TYPICAL 1ST TO 6TH FLOOR  
UNIT F-01  
BHK - 3  
CARPET AREA - 1221 SQFT  
BALCONY AREA - 273 SQFT  
BUA - 1552 SQFT  
SBUA - 2096 SQFT

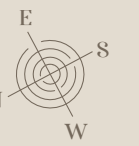
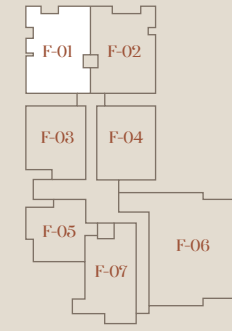

## UNIT PLANS



TYPICAL 1ST TO 6TH FLOOR  
UNIT F-03  
BHK - 3  
CARPET AREA - 966 SQFT  
BALCONY AREA - 190 SQFT  
BUA - 1216 SQFT  
SBUA - 1642 SQFT

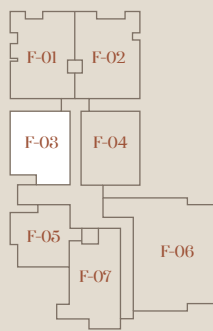

F-03



TYPICAL 1ST TO 6TH FLOOR  
UNIT F-04  
BHK - 3  
CARPET AREA - 986 SQFT  
BALCONY AREA - 222 SQFT  
BUA - 1270 SQFT  
SBUA - 1714 SQFT

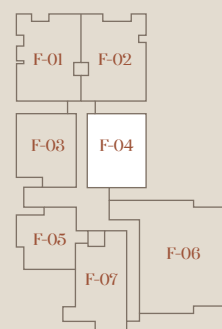

F-04



## UNIT PLANS



TYPICAL 1ST TO 6TH FLOOR  
UNIT F-05  
BHK - 2  
CARPET AREA - 764 SQFT  
BALCONY AREA - 204 SQFT  
BUA - 1020 SQFT  
SBUA - 1377 SQFT



F-05



TYPICAL 1ST TO 6TH FLOOR  
UNIT F-06  
BHK - 4  
CARPET AREA - 2260 SQFT  
BALCONY AREA - 501 SQFT  
BUA - 2862 SQFT  
SBUA - 3863 SQFT

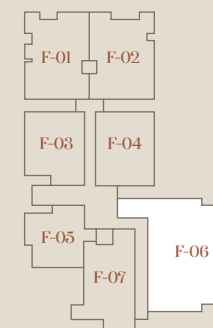

F-06



# UNIT PLANS



F-07

▲  
 TYPICAL 1ST TO 6TH FLOOR  
 UNIT F-07  
 BHK - 3  
 CARPET AREA - 1124 SQFT  
 BALCONY AREA - 165 SQFT  
 BUA - 1371 SQFT  
 SBUA - 1851 SQFT

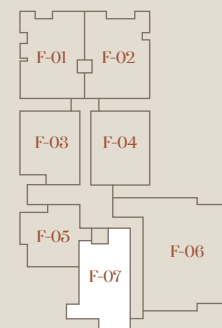

# TERRACE PLAN





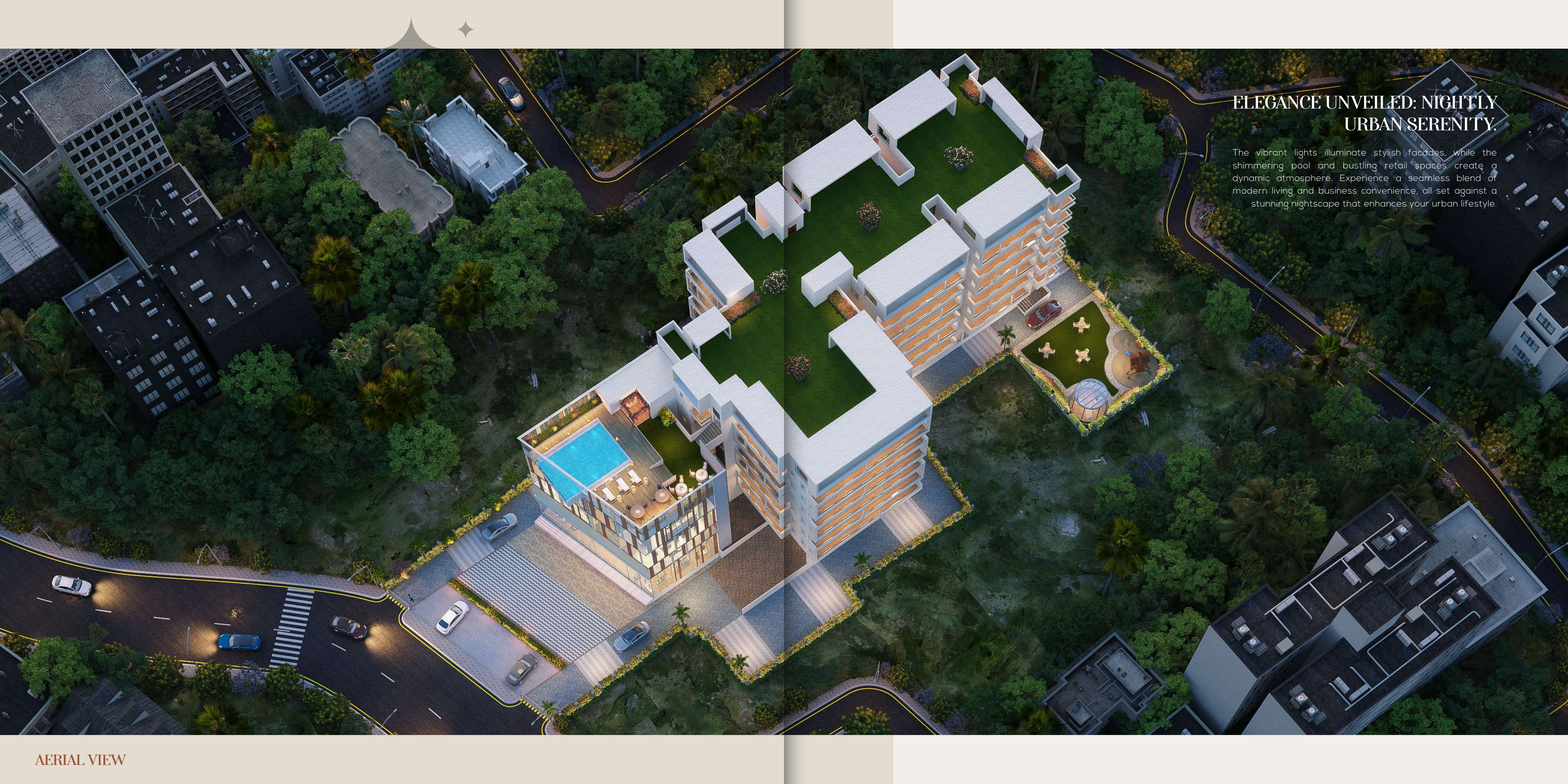

## ELEGANCE UNVEILED: NIGHTLY URBAN SERENITY.

The vibrant lights illuminate stylish facades, while the shimmering pool and bustling retail spaces create a dynamic atmosphere. Experience a seamless blend of modern living and business convenience, all set against a stunning nightscape that enhances your urban lifestyle.

## DEVELOPERS



**MAHANAGAR**

INFRACON PVT. LTD.

MAHANAGAR INFRACON PVT LTD  
401, Hem Plaza, Fraser Road  
Patna, Bihar - 800001  
Website - [www.mahanagarinfracon.com](http://www.mahanagarinfracon.com)

## ARCHITECT'S



Jaipur

## RERA NO

BRERAP32625-1/118/R-1756/2024

## SITE ADDRESS

CITY PRIDE  
Hajiganj, Patna City  
Patna Bihar - 800008

## MARKETING

9801111114, 8825118449

## DISCLAIMER

This brochure is not a legal document. It describes the conceptual plan to convey the intent and purpose of CITY PRIDE. The images are imaginary and the details mentioned in this brochure are tentative and subject to change at the sole discretion of the developer and/or architects.